

TO PHOENIX

TUCSON

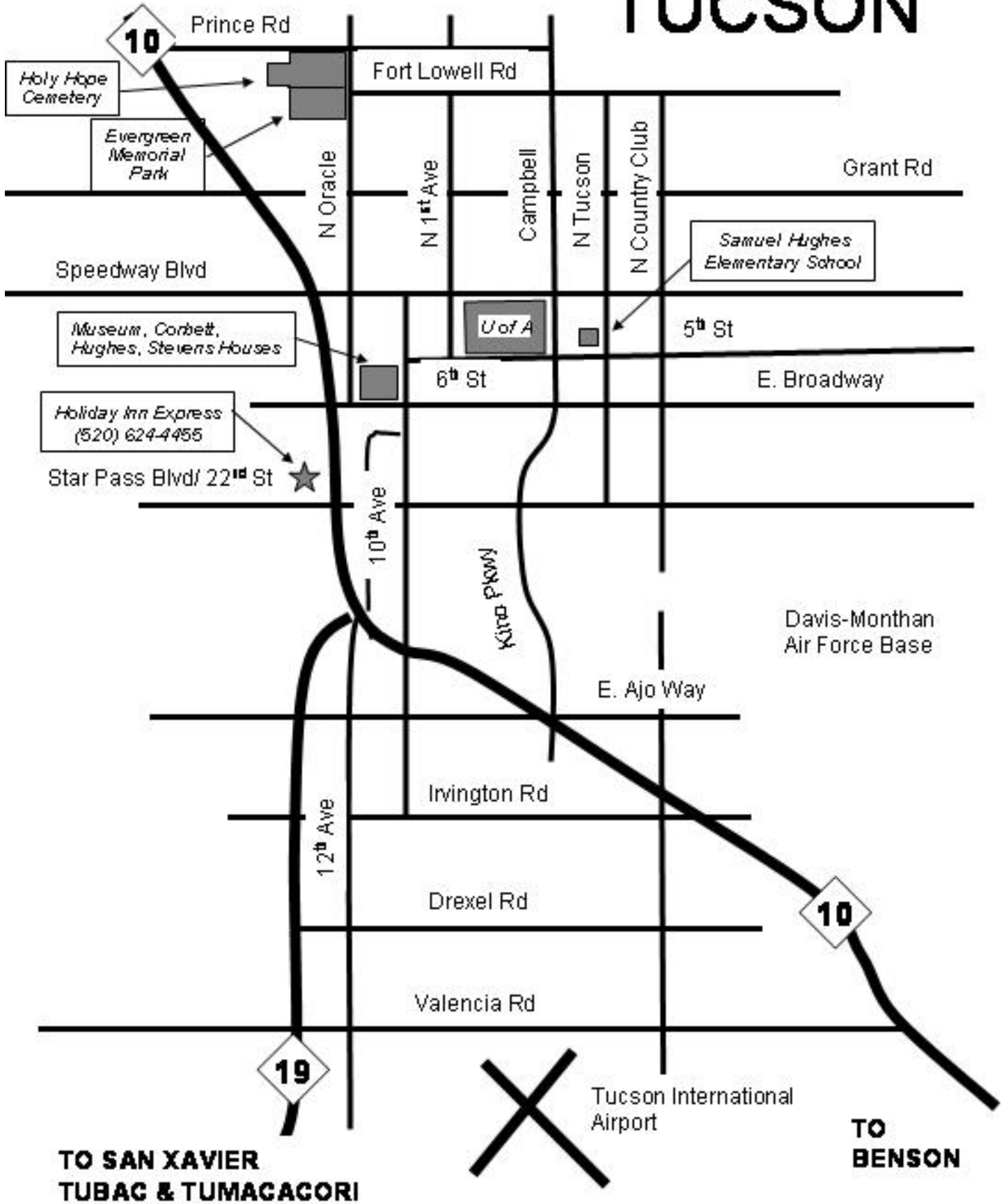

DOWNTOWN TUCCSON

- 35. 4th Avenue Merchants Mall
- 24. Artlink Station
- 20. Arizona Main Post Office
- Arizona State Buiden
- Center for Performing Arts
- City Hall Annex
- 8. El Presidio Park
- 10. El Presidio Plaza
- 33. El Tradido Walking Shrine
- 37. For Tucson Theatre
- 36. Gaucres Foodbridge
- 38. La Casa Condosa
- 32. Leo Rich Theatre
- 14. Museo Convencion & Visitors Bureau
- 16. Museum of Contemporary Art
- 34. Old Town Arizosana
- 17. Pima County Courthouse
- 9. Pima County Governmental Center
- 18. Floralad Theatre Center
- 21. St. Augustine Cathedral
- 22. State-Castro Fremont House
- 23. Temple of Music & Art
- 25. Tucson Arena & Exhibit Hall
- 1. Tucson Chamber of Commerce
- 5. Tucson Childrens Museum
- 6. Tucson City Courthouse
- 30. Tucson City Hall
- 7. Tucson Convention Center
- 26. Tucson Convention Center Music Hall
- 27. Tucson Federal Building
- 11. Tucson Federal Bus Station
- 13. Tucson Greyhound Bus Station
- 12. Tucson Main Fire Station
- 28. Tucson Main Library
- 19. Tucson Main Police Station
- 15. Tucson Main Post Office
- 3. Tucson Museum of Art
- 31. Tucson Sculpture Garden
- 29. Tucson YMCA
- 38. Verde De Agosto Park

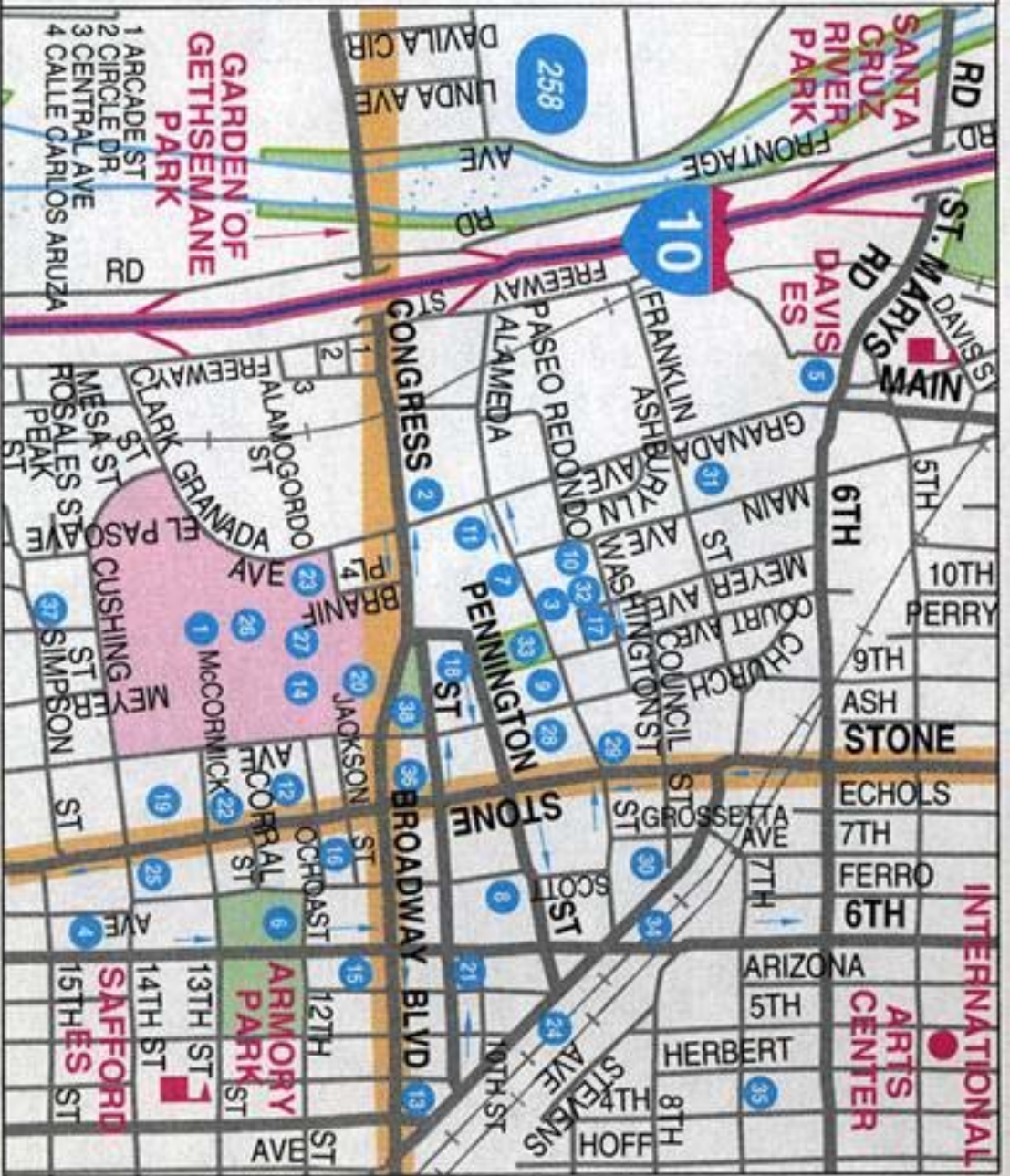

HOME OF SAM E. ATANACIA
SEE PICTURE 25

HISTORICAL LANDMARKS



LEGEND

- 1 CAMINO REAL
- 2 PADRE KINO MONUMENT
- 3 MISSION SAN XAVIER DEL BAC
- 4 MISSION OF MYSTERY (SAN JOSE OR SAN COSME)
- 5 OJITO SPRINGS (WATERING PLACE OF FIRST TRAVELLERS, LATER PUBLIC)
- 6 WARNER'S STORE
- 7 WARNER'S MILL
- 8 PETE KITCHEN'S LAST HOME
- 9 FIRST WISHING SHRINE
- 10 PRESENT WISHING SHRINE
- 11 SILVER LAKE
- 12 SAN AGUSTIN DE OYAU (3 LEAGUES N.W.)
- 13 MILITARY PLAZA (LA PLAZA DE LAS ARMAS)
- 14 THE OLD WALLED CITY
- 15 CHAPEL OF THE PRESIDIO
- 16 SOLANO LEON'S CHAPEL
- 17 SITE OF FIRST COURT HOUSE
- 18 FIRST AMERICAN FLAG FLOWN HERE (RAISED BY MORMON BATTALION)
- 19 LEATHERWOOD'S STABLES
- 20 ORNDORFF HOTEL (HODGES HOUSE, COSMOPOLITAN HOTEL, LEVINS HOTEL)
- 21 WHIPPING POST (OLD COURT HOUSE)
- 22 TULLY & OCHOA'S STABLES
- 23 LORD & WILLIAMS CORRAL
- 24 SAN AGUSTIN CHURCH
- 25 SISTERS OF ST JOSEPH ACADEMY
- 26 FIRST PUBLIC SCHOOL (FIRST YEARS BUDGET INCLUDING BUILDING S1361.)
- 27 J. S. MANSFIELD NEWSDEPOT
- 28 ZECKENDORF'S STORE
- 29 OLD CEMETERY
- 30 CAPITOL BUILDINGS
- 31 GIRLS SCHOOL (MRS. JOSEPHINE BRAWLEY HUGHES 1873)
- 32 FIRST OWL'S CLUB
- 33 GAY ALLEY (NAMED AFTER CAPT. GAY)
- 34 SITE OF MEXICAN CIRCUS
- 35 OCCIDENTAL OR PALACE HOTEL
- 36 CARILLO'S GARDENS
- 37 LEVIN'S GARDENS
- 38 OVERLAND STAGE STATION
- 39 TOMBSTONE STAGE STATION
- 40 CAMP LOWELL

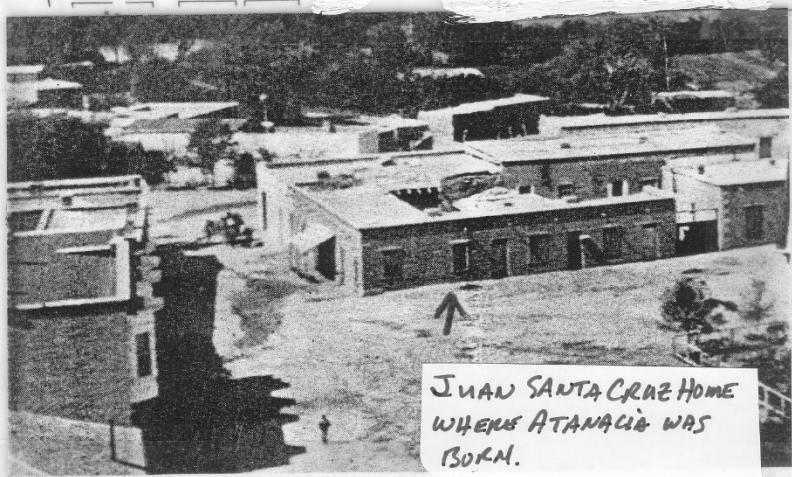
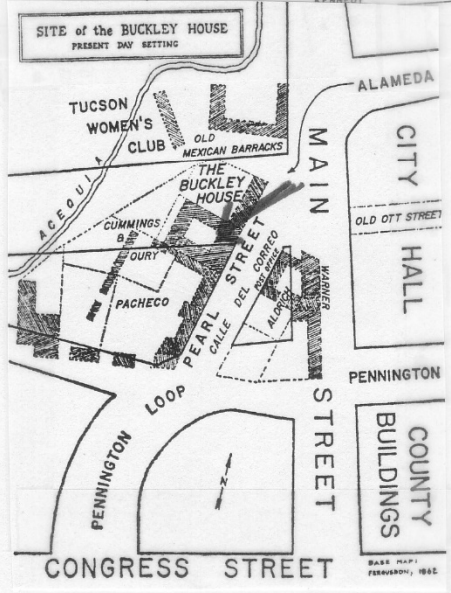
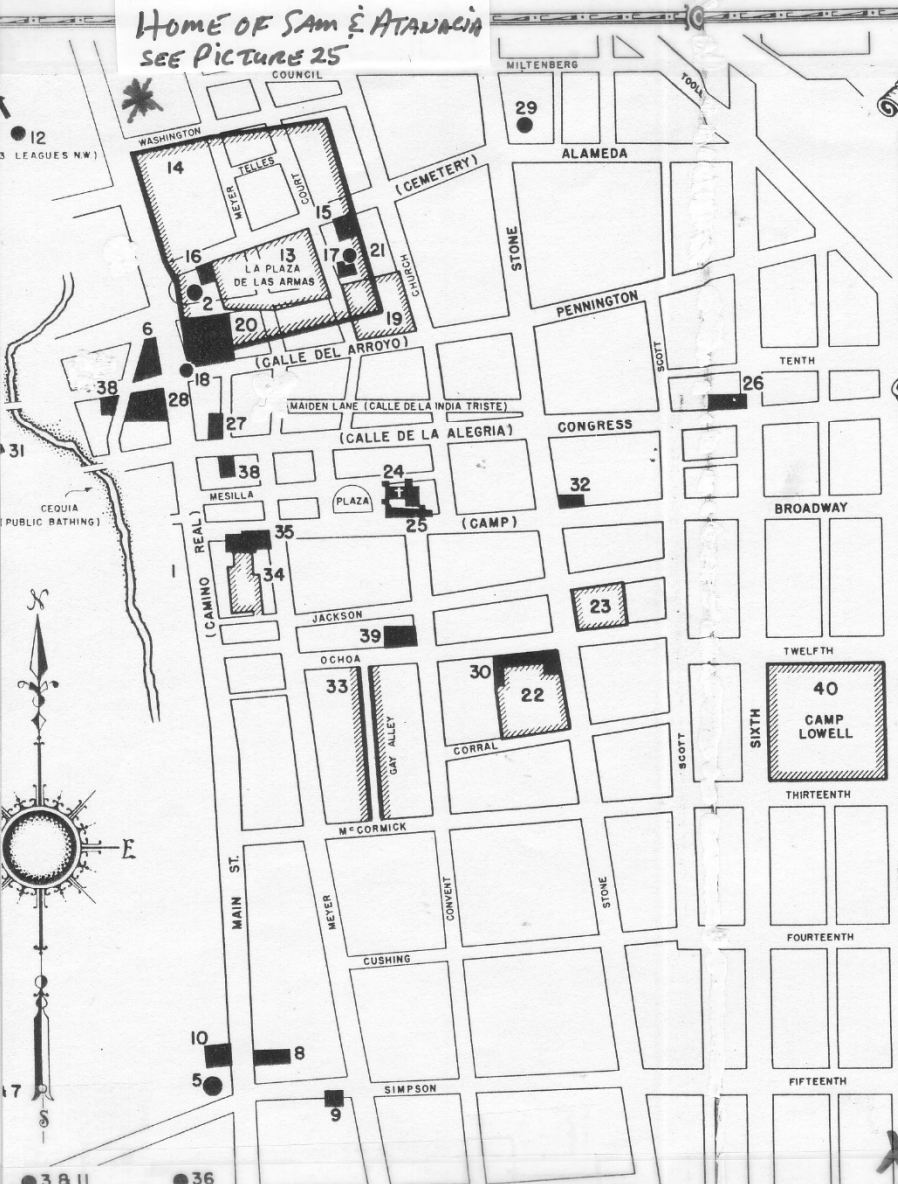

JUAN SANTA CRUZ HOME
WHERE ATANACIA WAS
BORN.

ONLY KNOWN PHOTOGRAPH OF THE BUCKLEY HOUSE

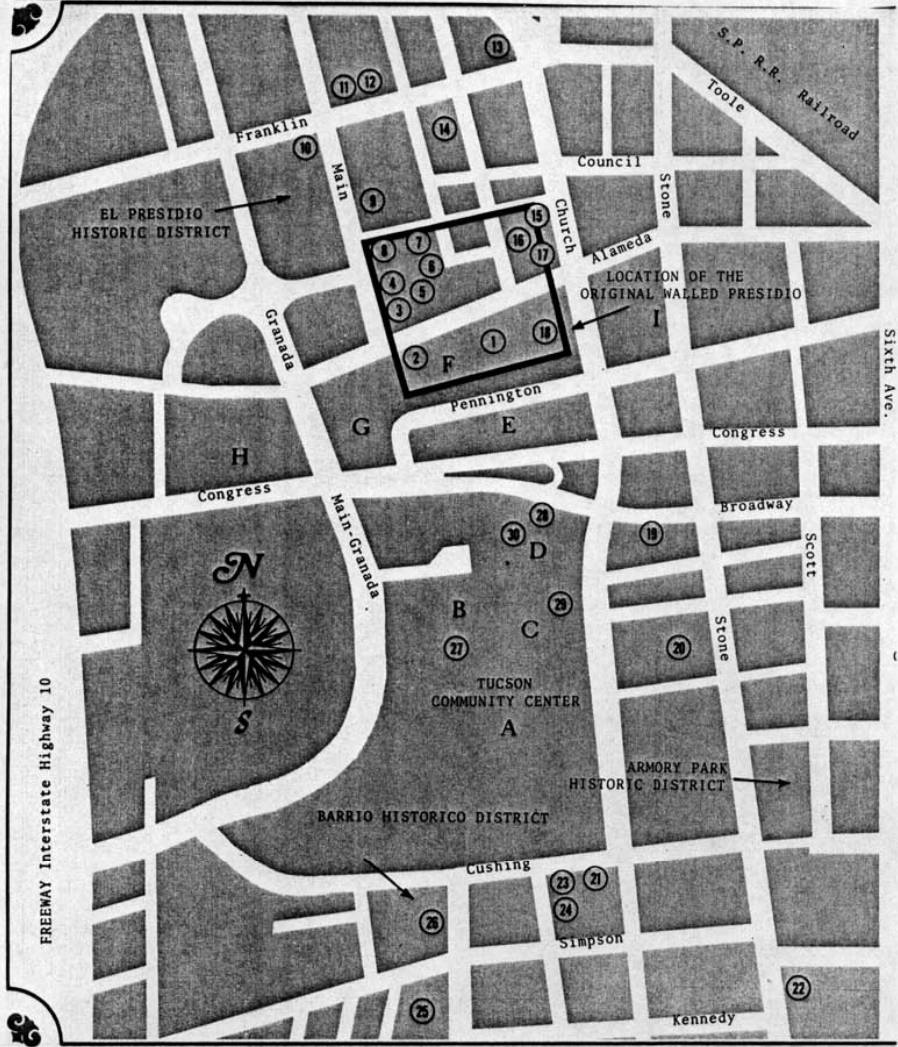

- (4) Hiram & Petra Stevens House (Atanacia's sister)
- (5) Tucson Museum of Art
- (8) Corbett House (J.Knox Corbett and Isabel Hughes Corbett)
- (9) Sam Hughes House (private residences)
- (27) Soza-Carrillo-Fremont House (Atanacia's harp on display)

*Downtown
Historic
District*

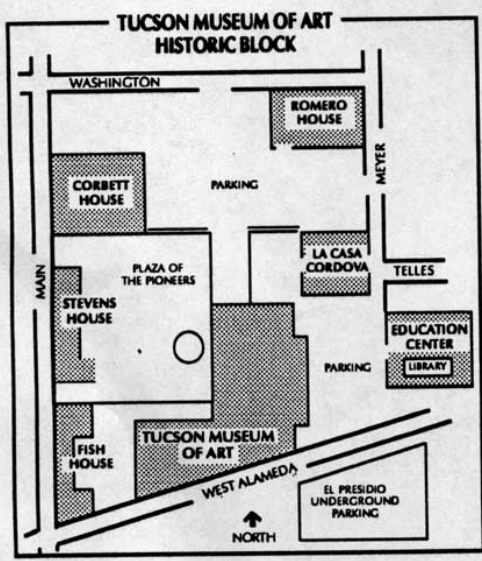

FAIRVIEW



Evergreen MORTUARY
CEMETERY & MEMORIAL PARK

3015 NORTH ORACLE ROAD
TUCSON, ARIZONA 85705
24 Hour Telephone -- (602) 888-7470

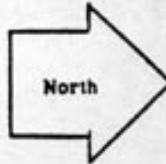
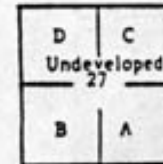
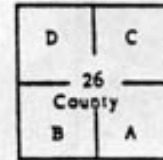
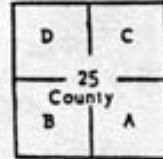

WELL

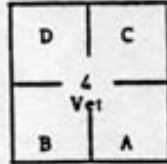
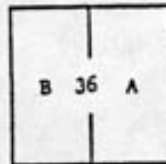
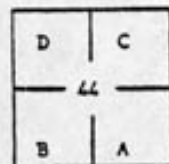
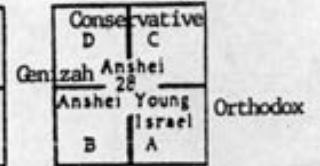
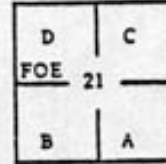
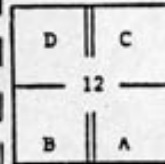

T H

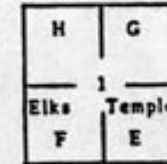
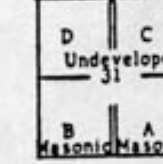
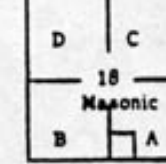
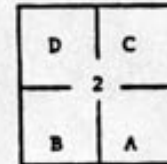
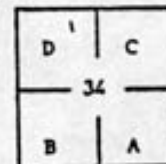
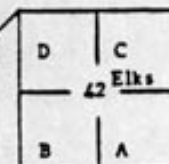
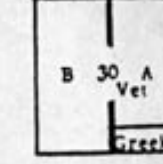
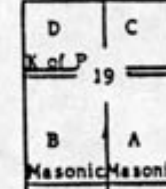
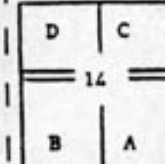
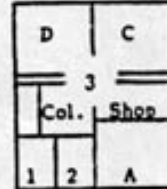
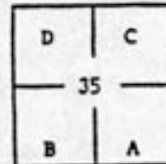
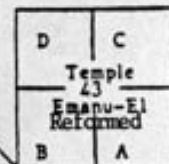
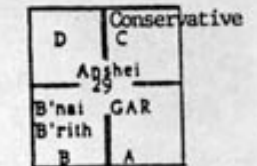
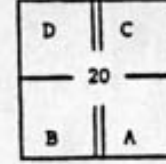
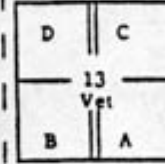

Bridge

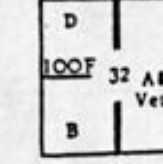
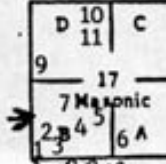
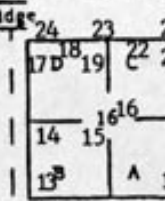

W. MIRACLE MILE
Miracle Mile Entrance

Oracle Entrance

Ft. Lowell Entrance

Sam

Map 101

HOLY HOPE CEMETERY
And MAUSOLEUM

3555 N. Oracle Road
Tucson, Arizona
888-0860

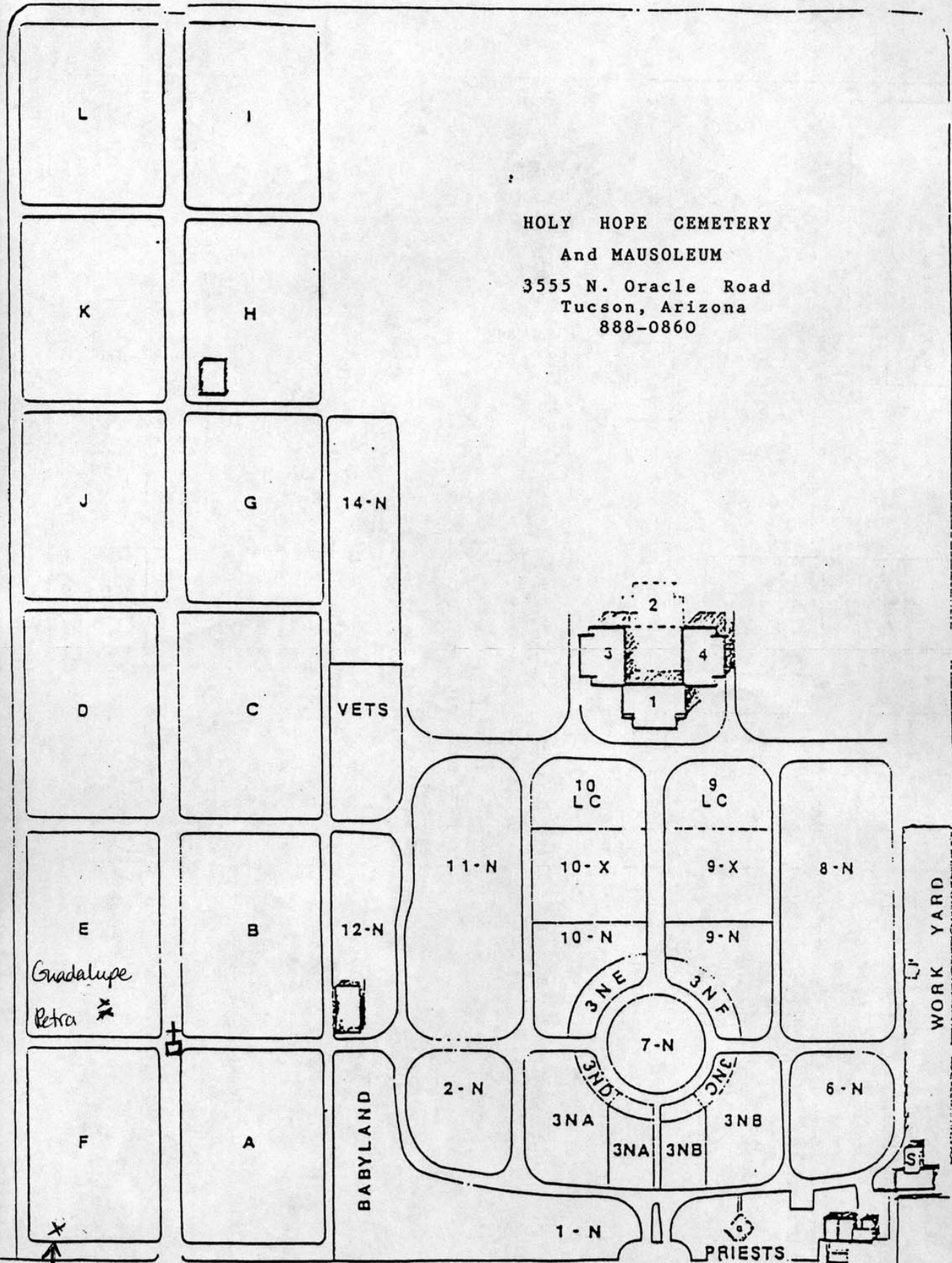

Gradalupe
Petra ✕

Athencia

WORK YARD

PRIESTS

North
→

DATE

SIM RUGHES HOUSE
 205 N. MAIN STREET
 TUCSON, PIMA COUNTY, ARIZONA

PLAN & FORM-CHANGES
 1885 TO PRESENT, 1968
 SCALE: 1" = 50'-0" (5)

N. MAIN STREET

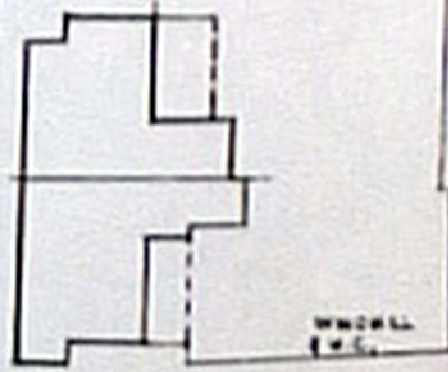

1885 - SANBORN FIRE MAP

N. MAIN STREET

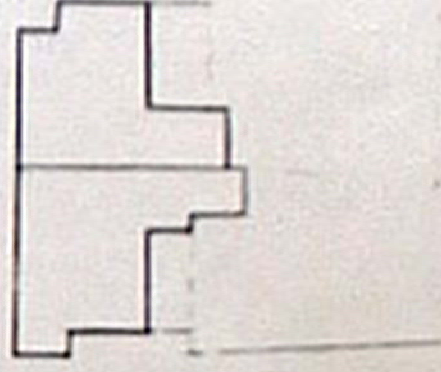

1889 - SANBORN FIRE MAP

N. MAIN STREET

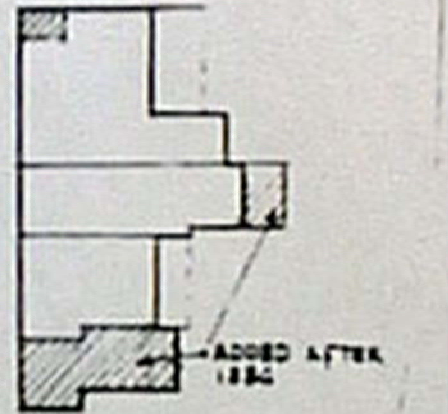

1901 - SANBORN FIRE MAP

N. MAIN STREET

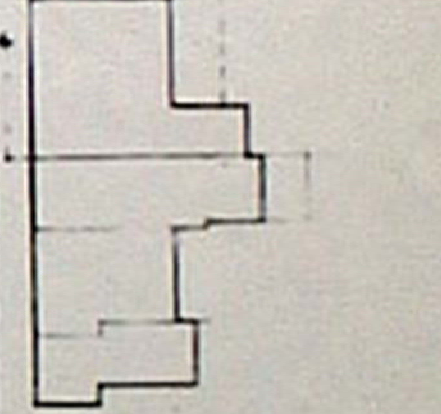

1909 - SANBORN FIRE MAP

N. MAIN STREET

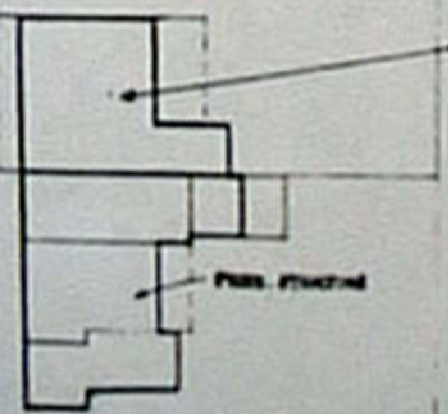

1914 SAME AS 1909

N. MAIN STREET

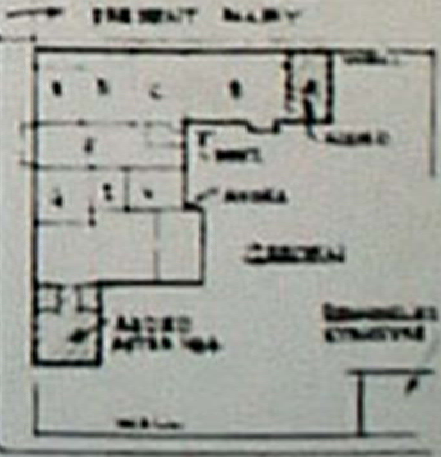

PRESENT

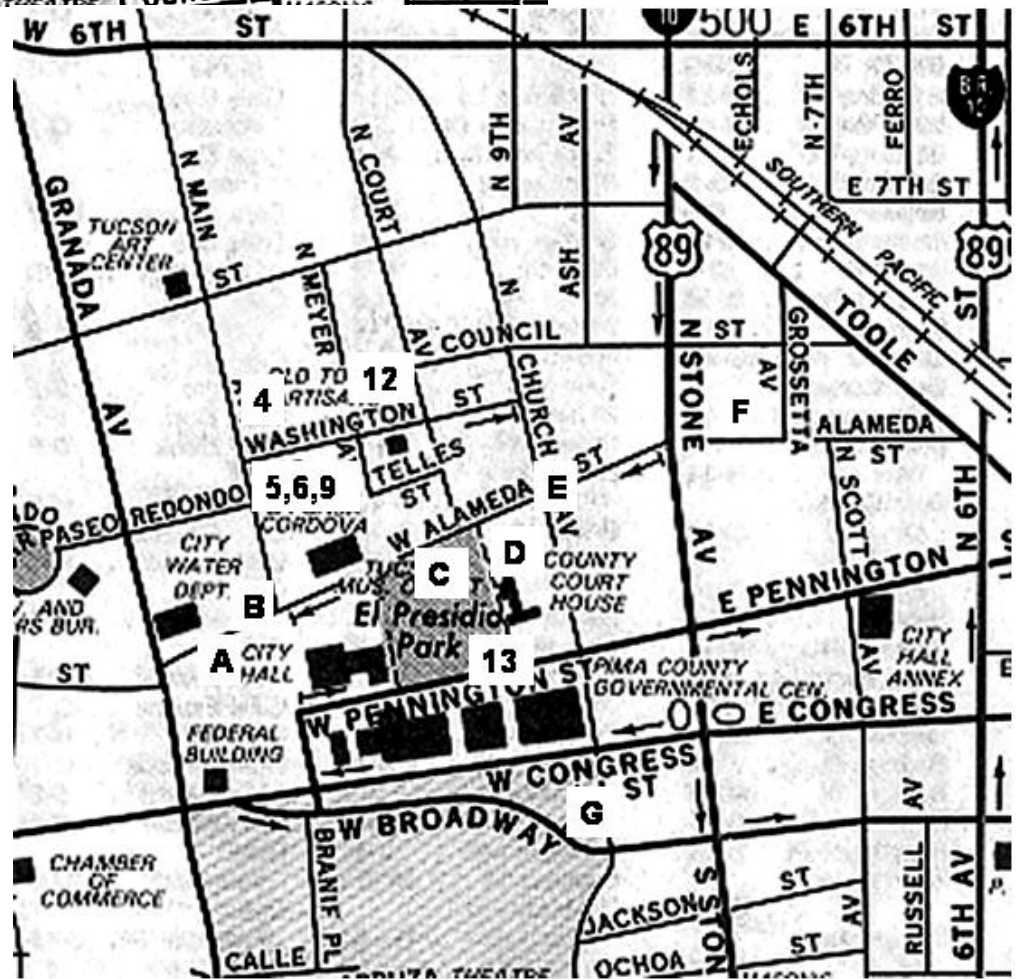
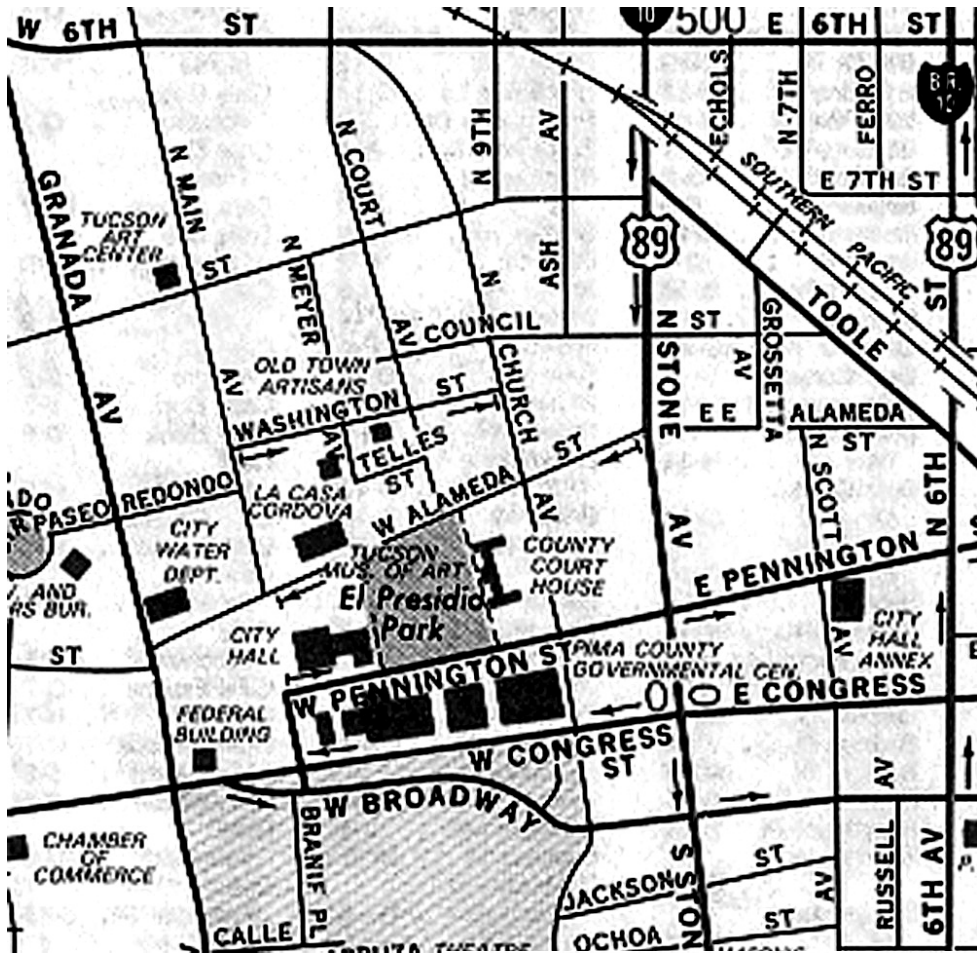

Benson to Tumacacori

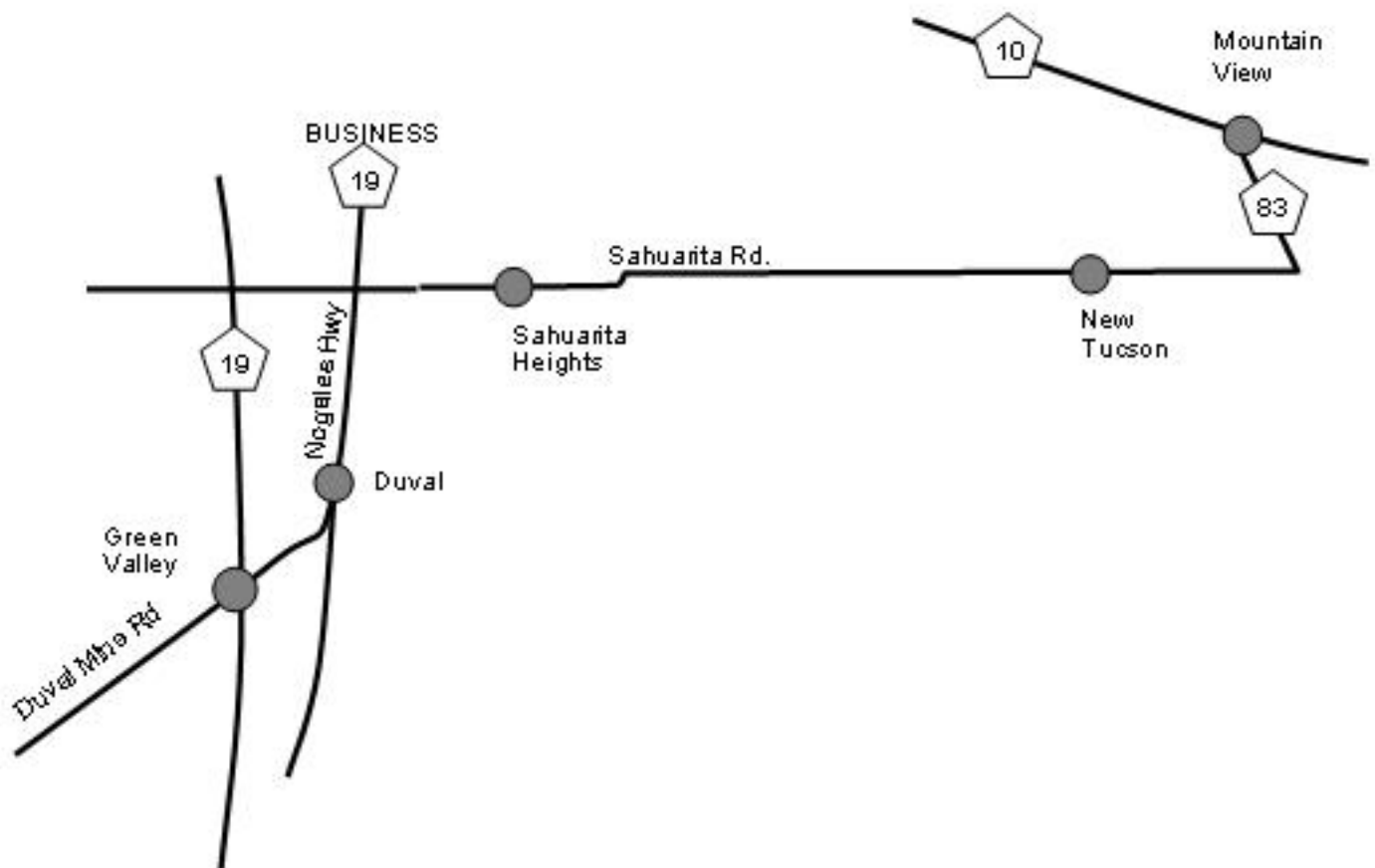
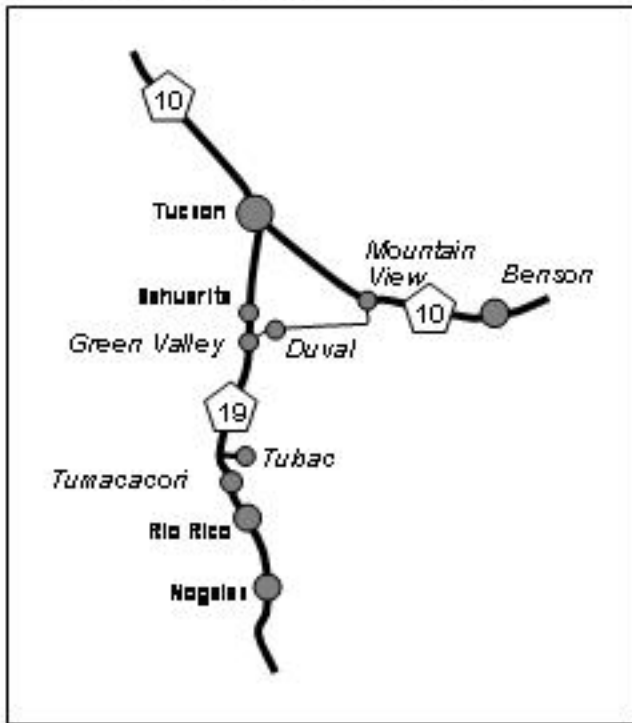

San Xavier, Tubac Precidio & Tumacacori National Park



Mission San Xavier del Bac

Tubac Precidio

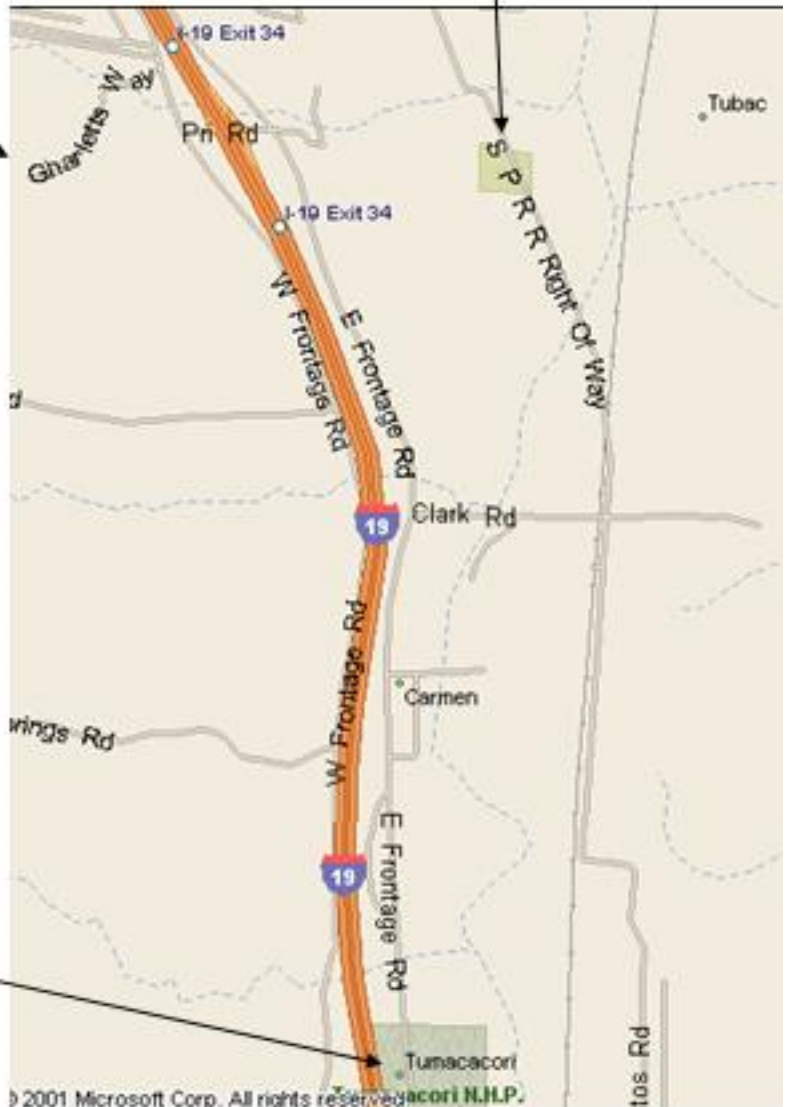

Tumacacori National Park

7

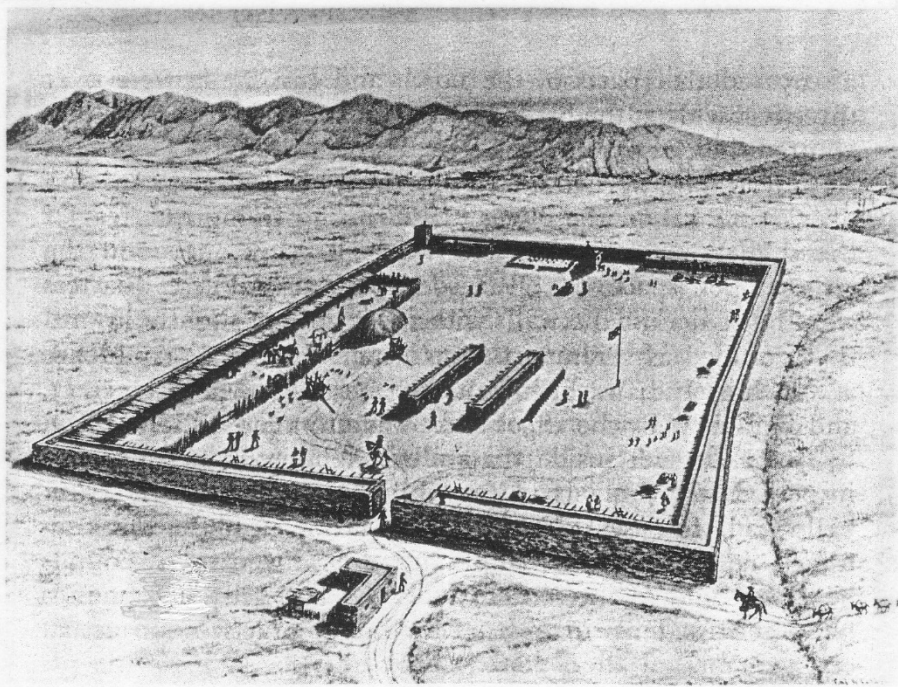

An artist's concept of the Royal Presidio of Tucson

X: JUAN SANTA CRUZ HOME
ROYAL PRESIDIO OF TUCSON
ATANACIA A CHILD
MORMON BATTALION

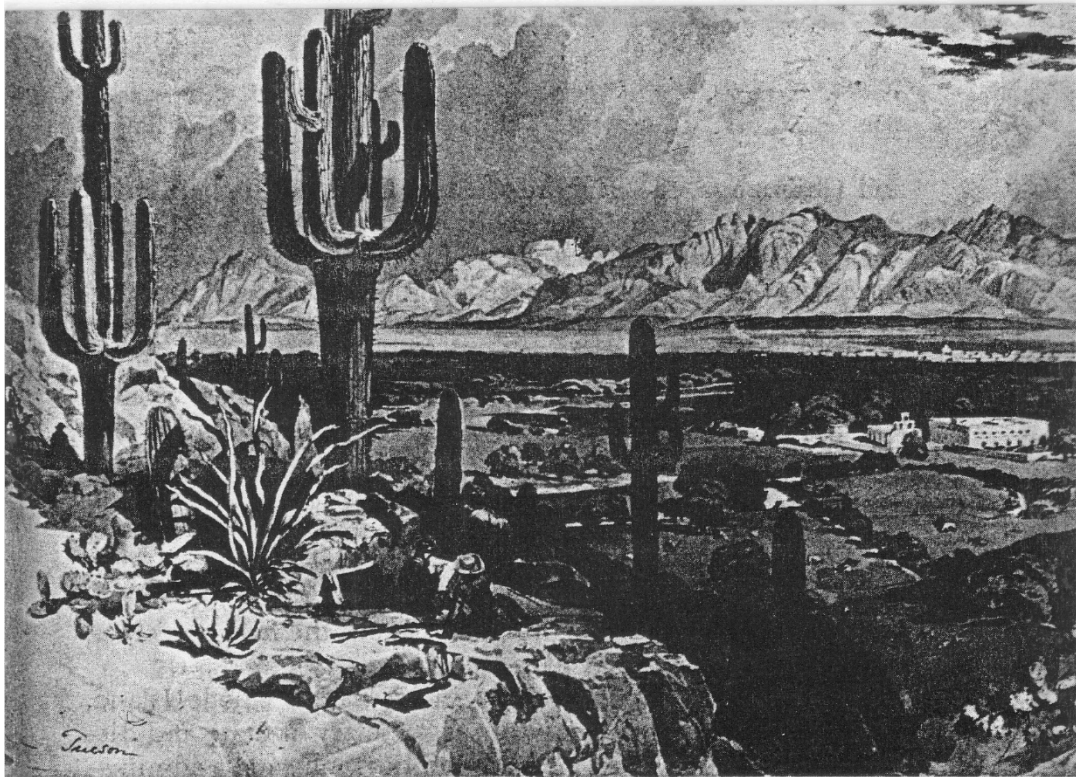

University of Arizona Library

Sketch of Tucson, by John Bartlett, 1852

TUCSON 1852
SAM ARRIVED 1858

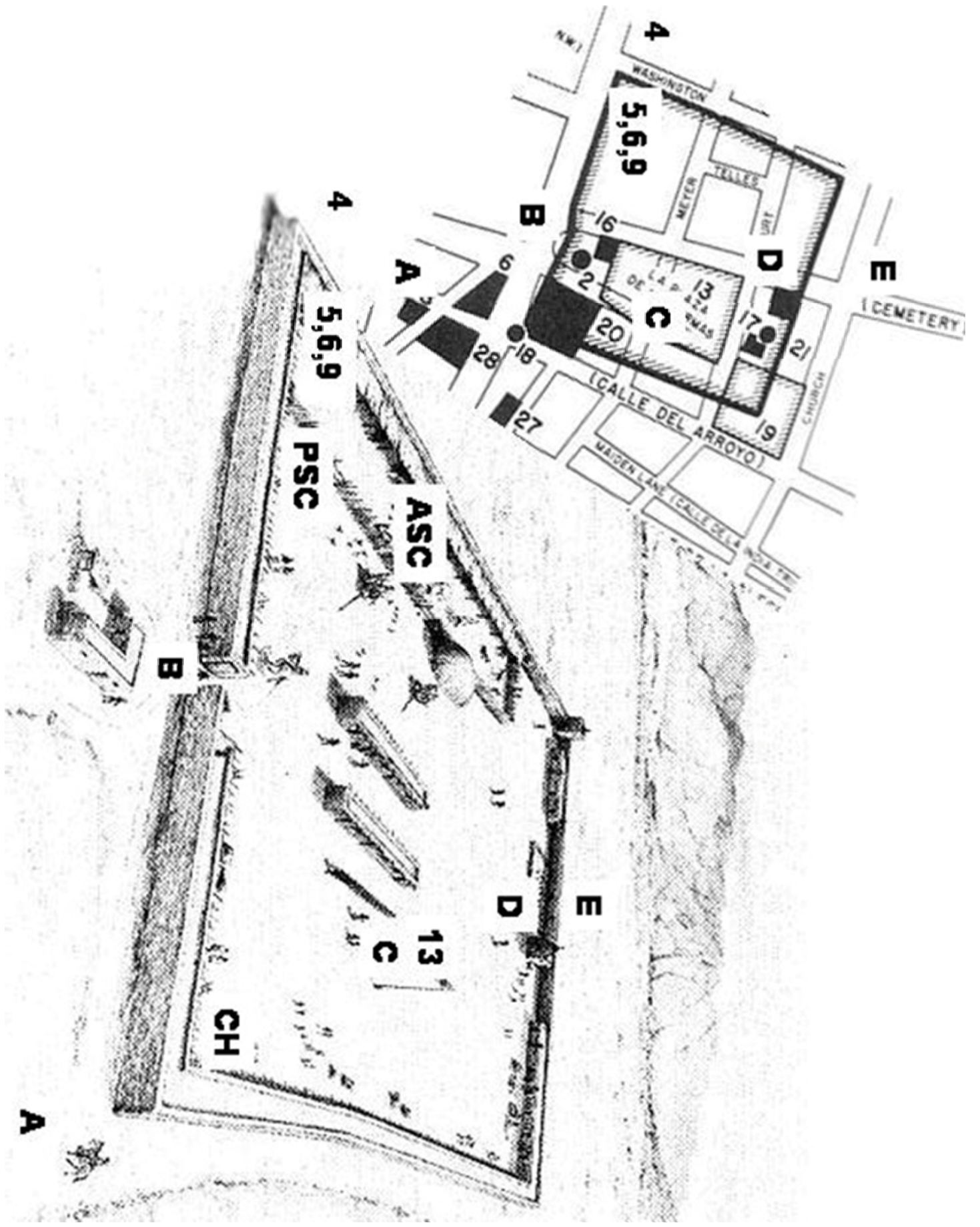

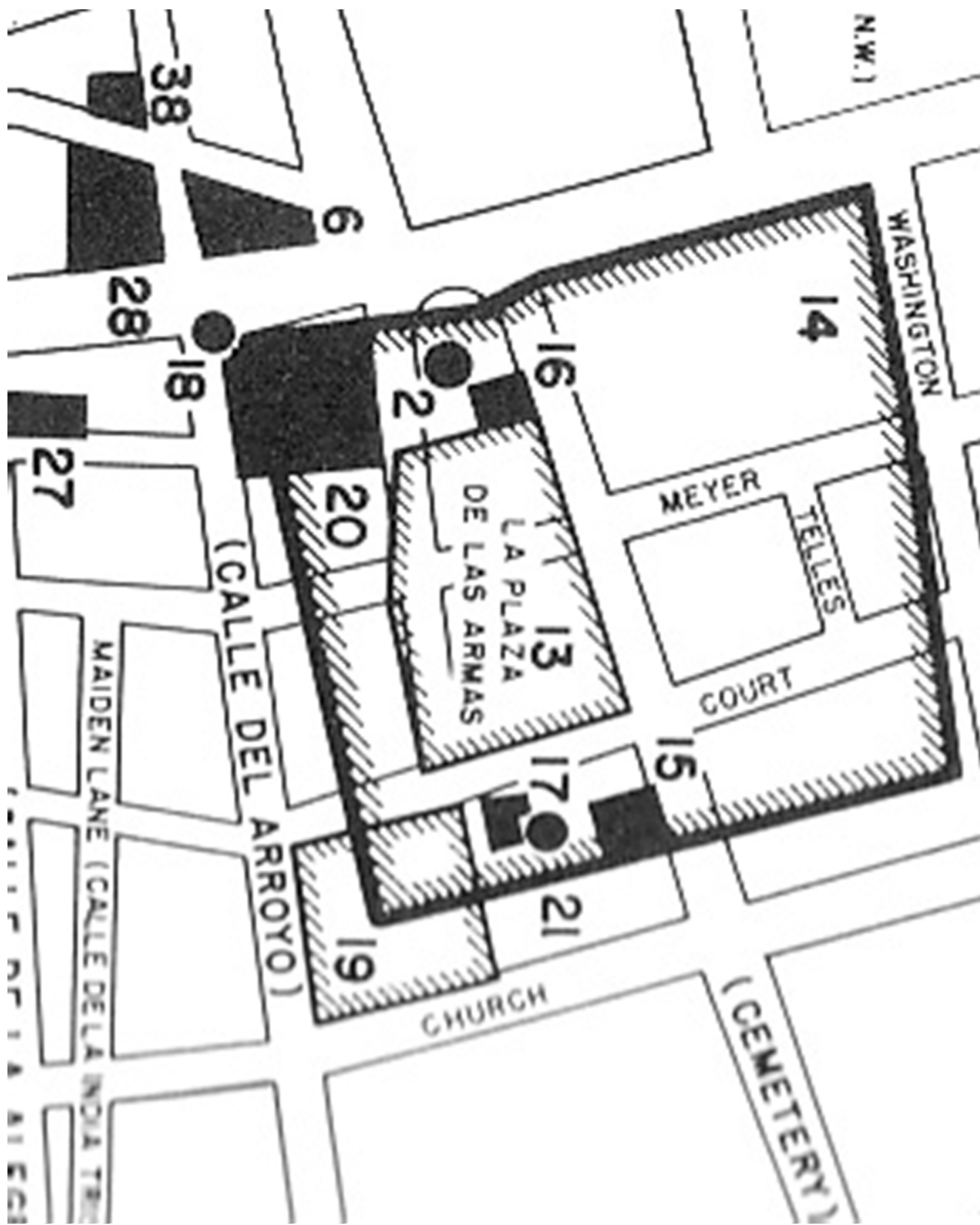

The Northern Pimería Alta, 1691 - 1767

LEGEND

- Mission Cabecera
- Indian Village
- Present-day City
- Hacienda, Rancho, or Mining Site
- Vista
- Presidio

Scale in Miles
0 10 20

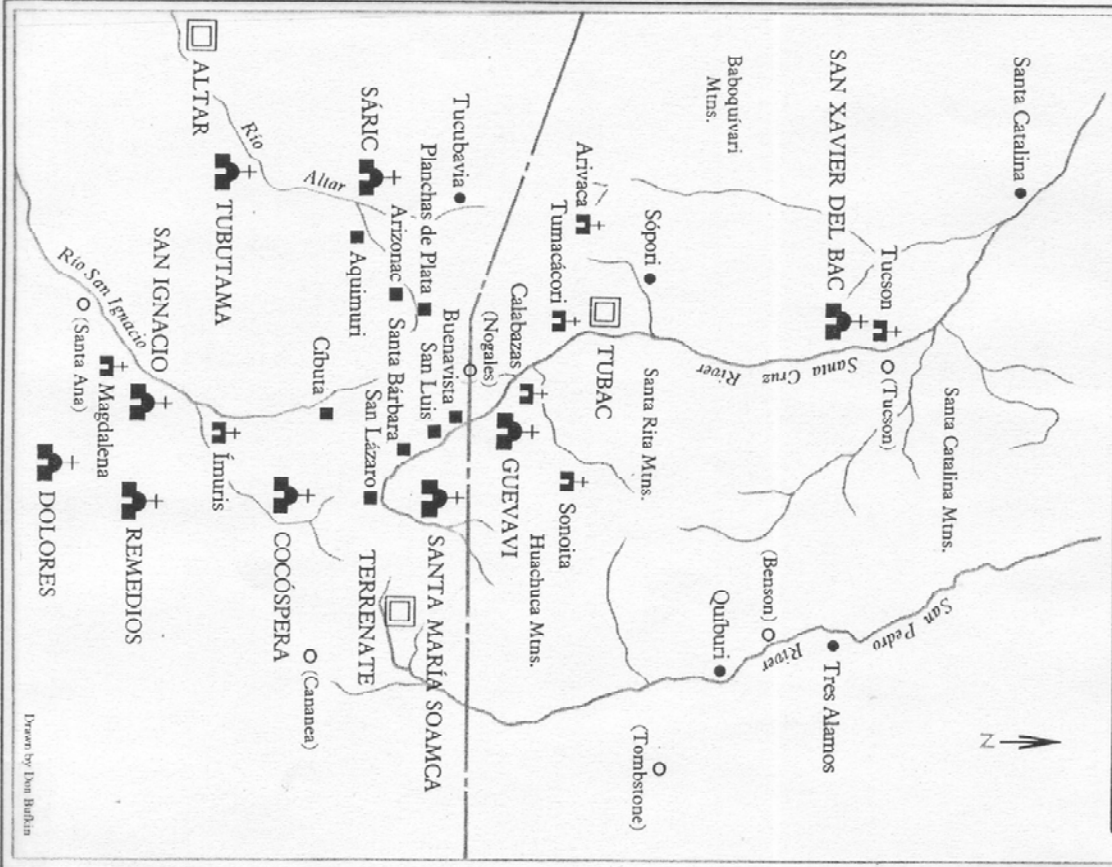

Drawn by Dan Hoffman

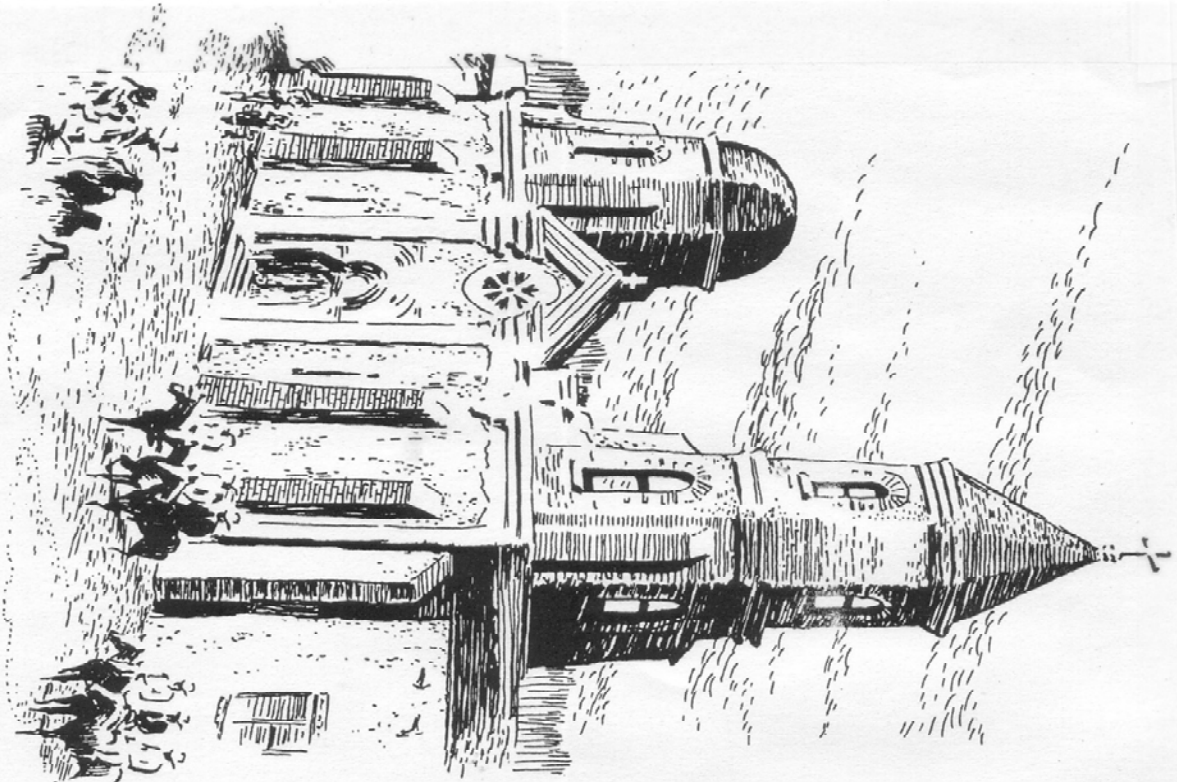

SAN AGUSTIN CHURCH

6

* ATAVACIOS FAMILY - EITHER DIRECT 8000 OR BY MARRIAGE

CORRIENED GRANTS = 244,320 ac = 458 mi²
 AREA CLAIMED = 2,531,616 ac = 3,939 mi²

THEY CLAIMED THEY OWNED 9 TIMES MORE LAND THAN WAS CONFIRMED
 BY THE U.S. GOVERNMENT - 9 TIMES MORE
 THAN WHAT YOU SEE ON THIS MAP

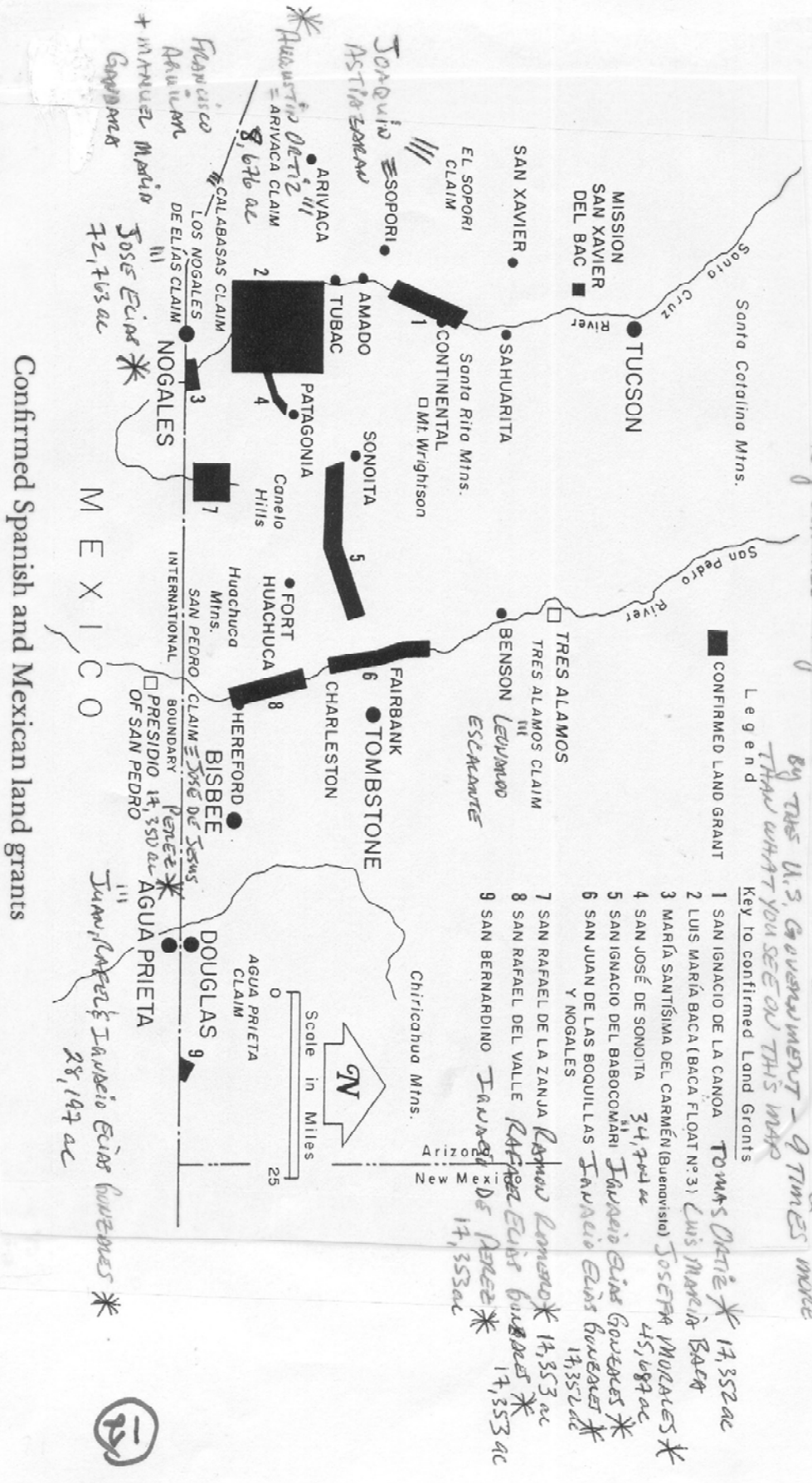

(15)

#3

13

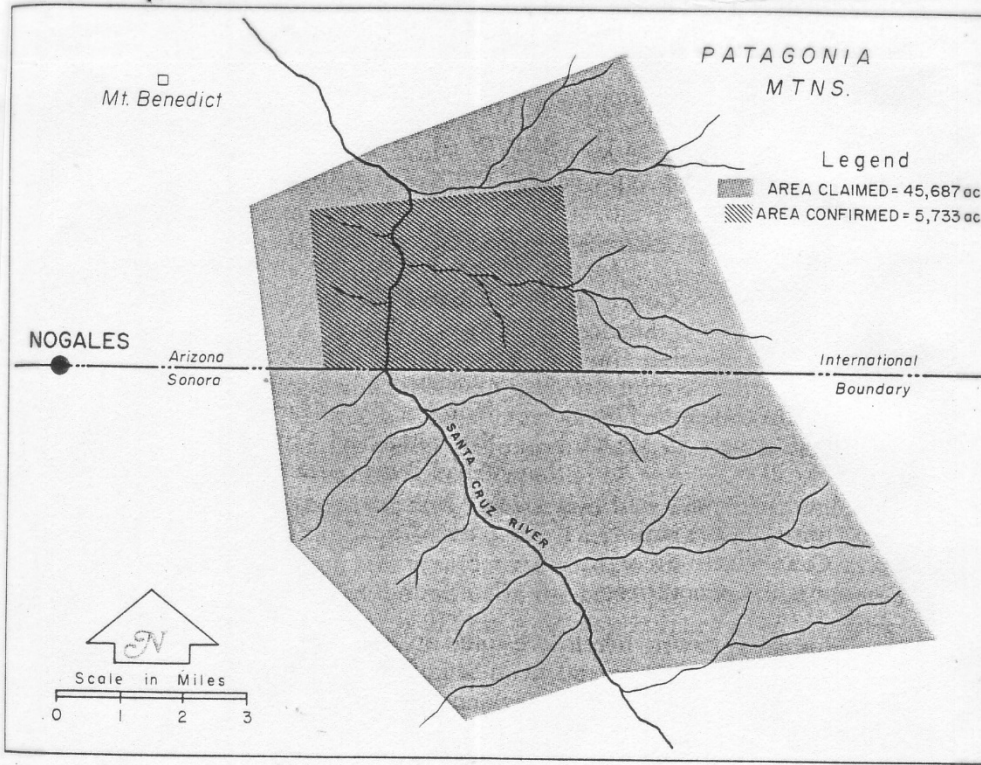

Buenvista grant **MORALES**

#7

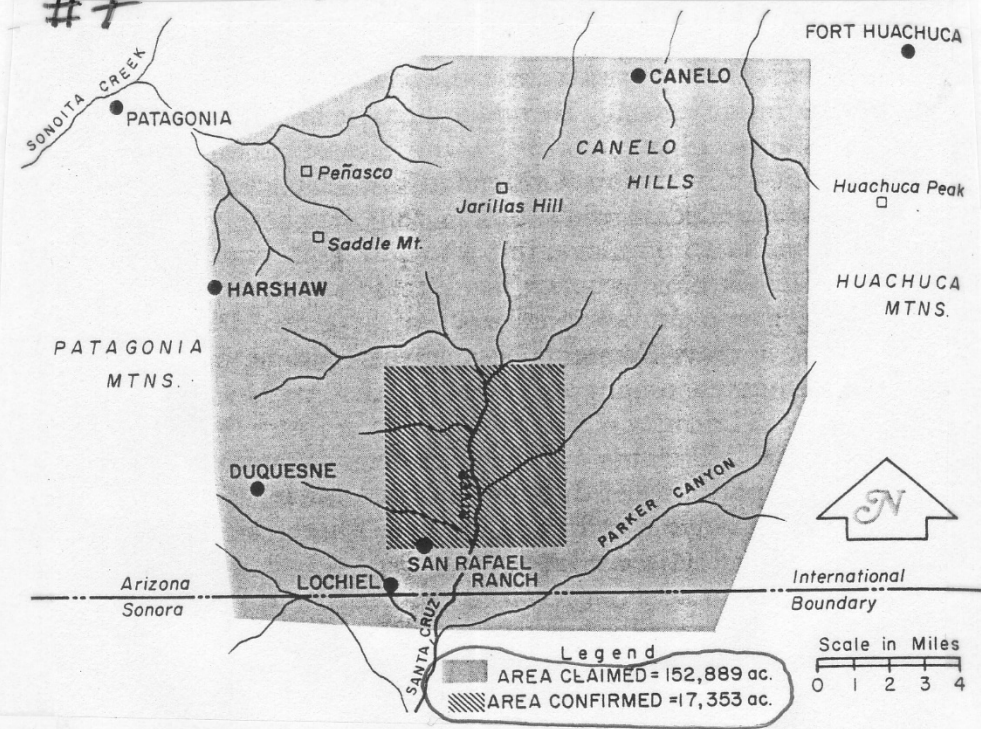

San Rafael de la Zanja Grant
ROMERO

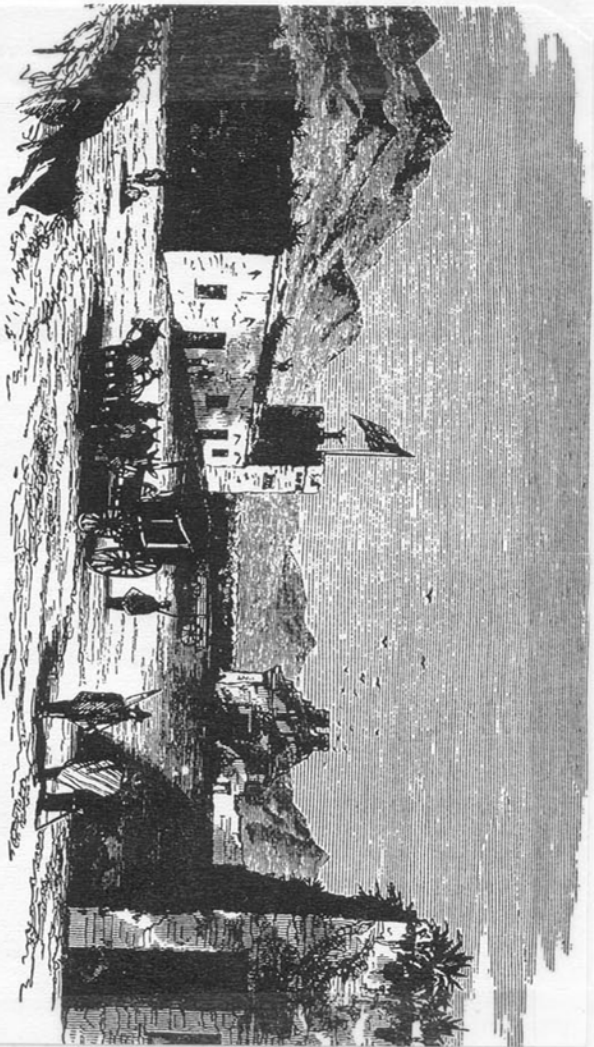

J. Ross Browne, *A Tour Through Arizona*, 1864
 Tubac was the center of civilization in Arizona during the late 1850s but was abandoned to the Apaches by the time Browne visited there in 1864 and sketched this picture.

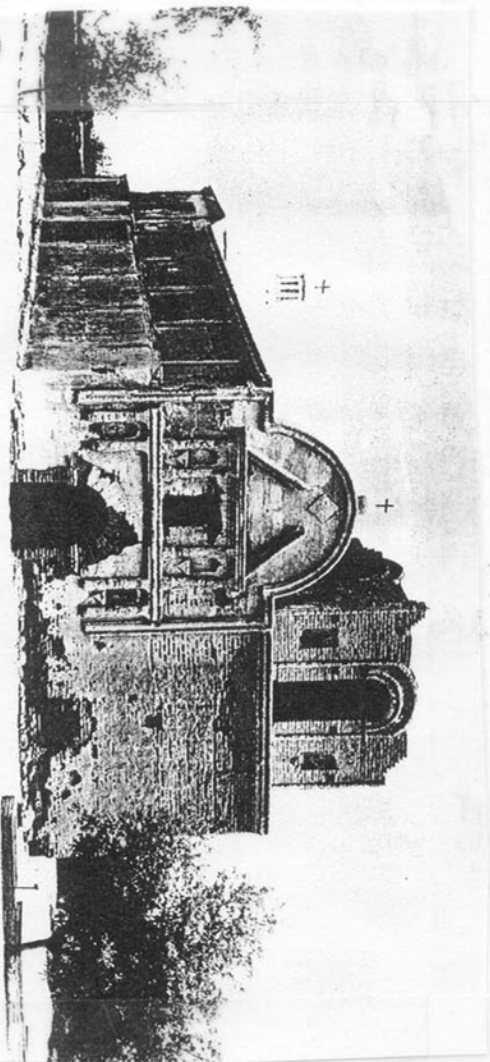

Arizona Historical Society
 Mission of San Cayetano del Tumacacori after restoration c. 1920

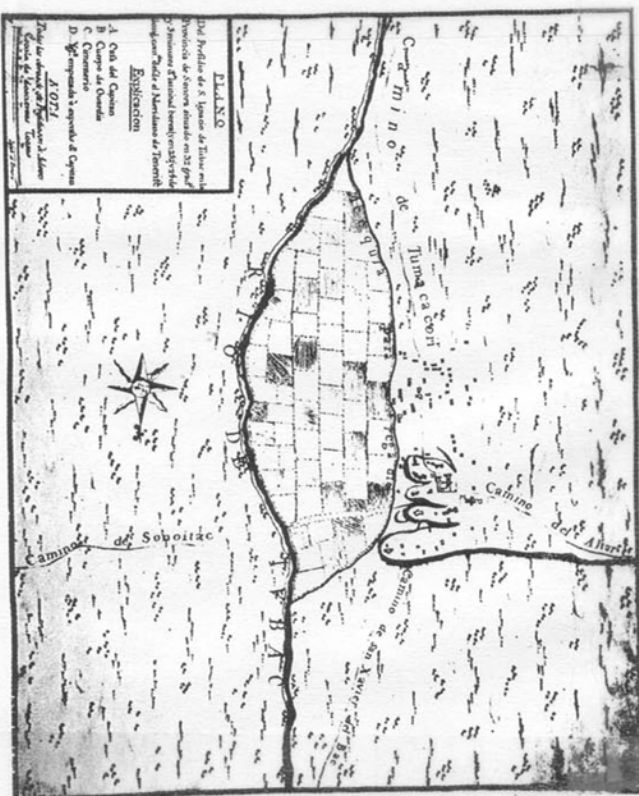

Map of the presidio of San Ignacio del Tubac, prepared in 1766 by cartographer Joseph de Urrutia (British Museum, courtesy of the Arizona State Museum, University of Arizona)

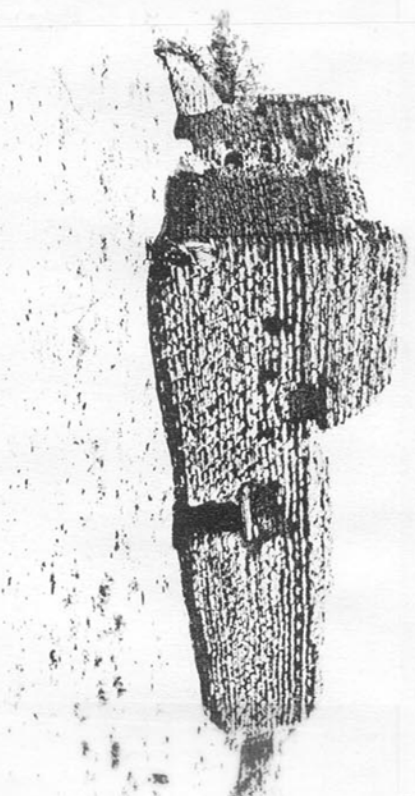

Ruins of the Guevavi Mission in 1889 (George Roskrutge photograph, Arizona Historical Society)

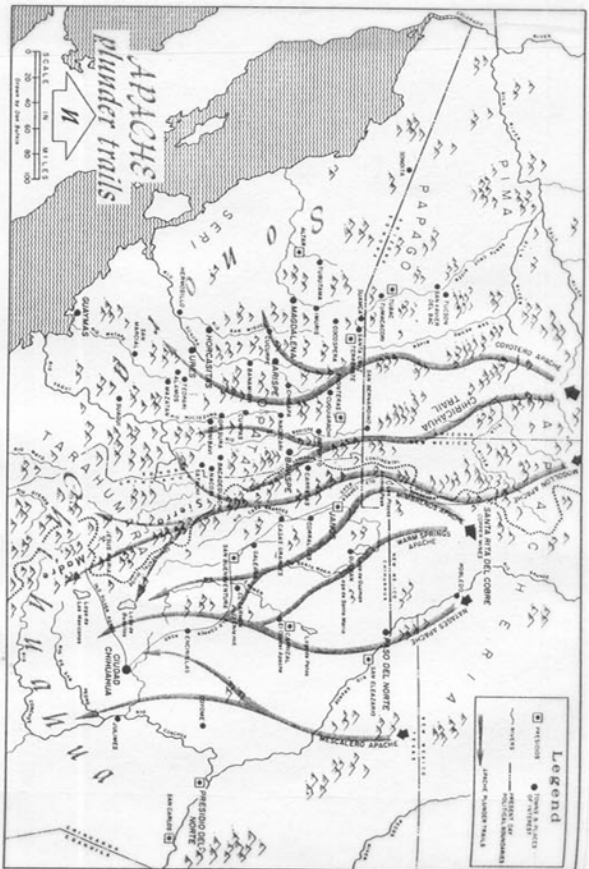
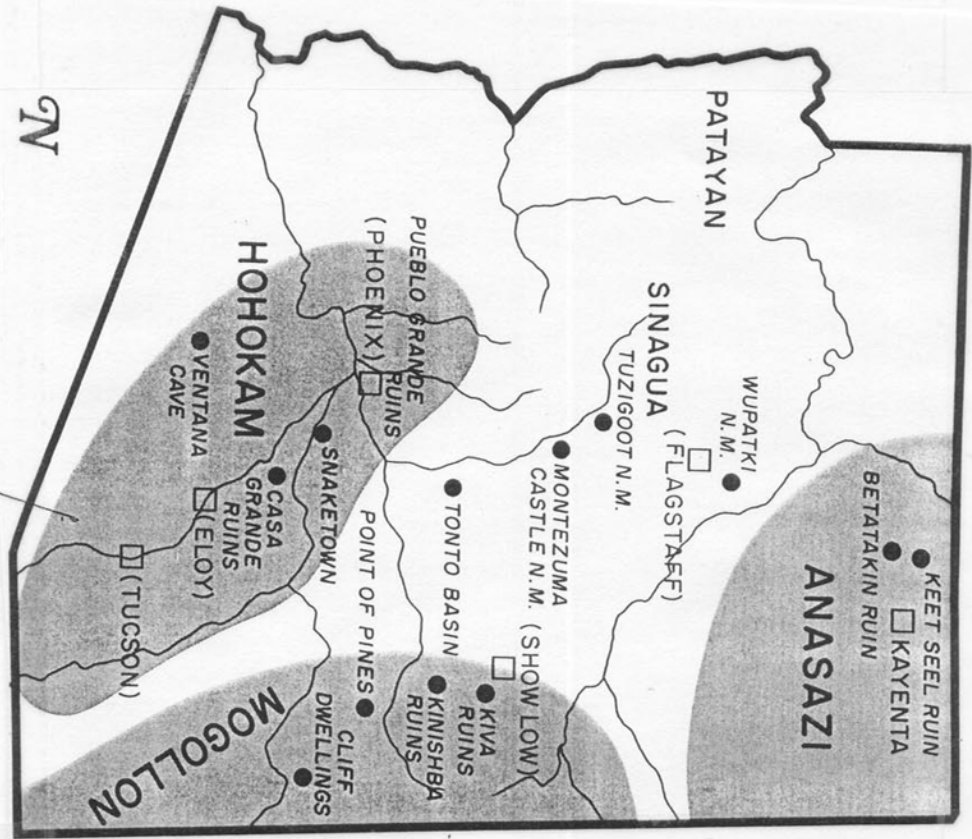

Apache plunder trails

Francisco Gonzalez

Signature of Francisco Elias Gonzalez de Zayas, commanding officer at Terrenate, 1752-1770, and founder of the Elias family of Sonora (Archivo General de Indias)

(19)

Celtic cross

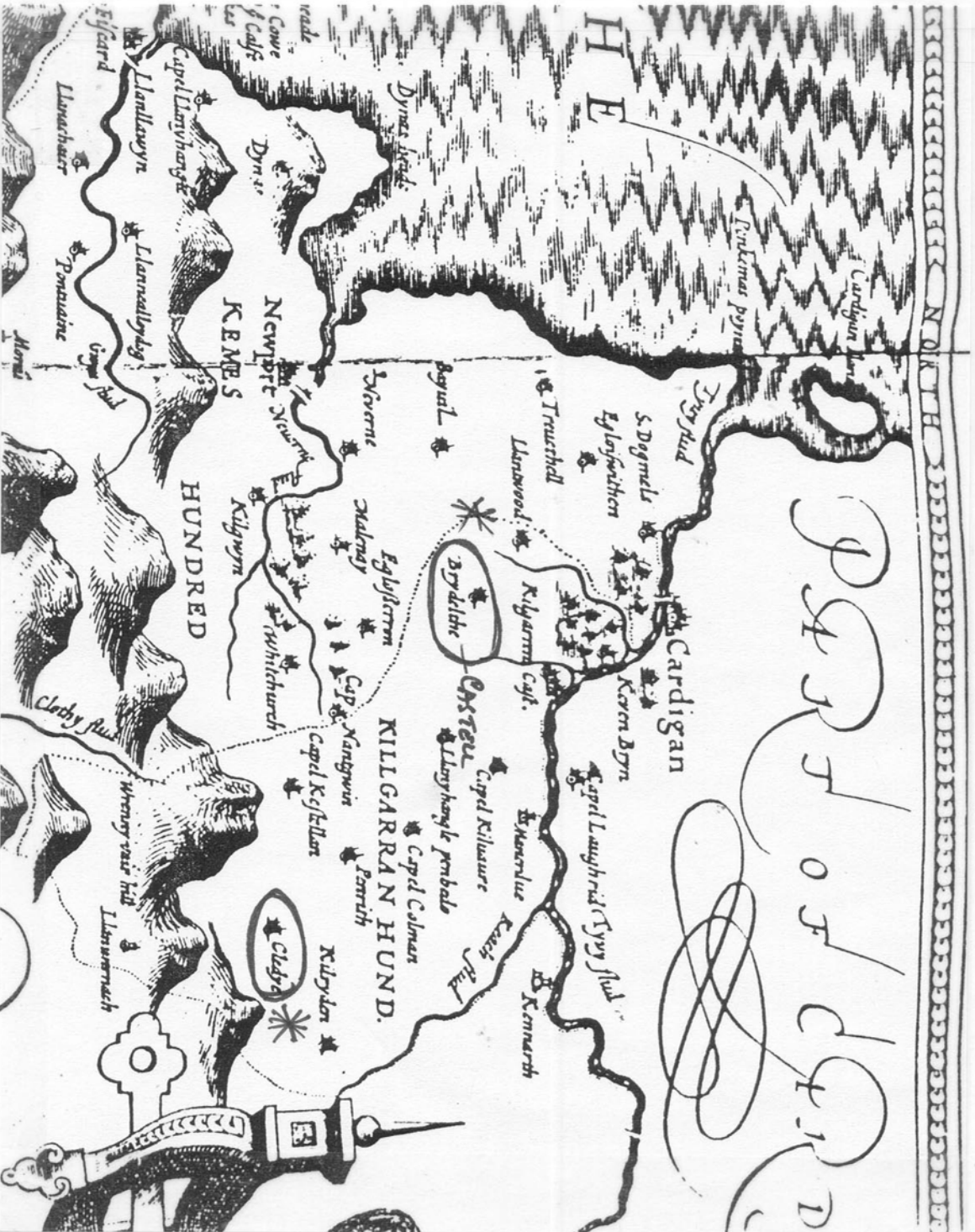
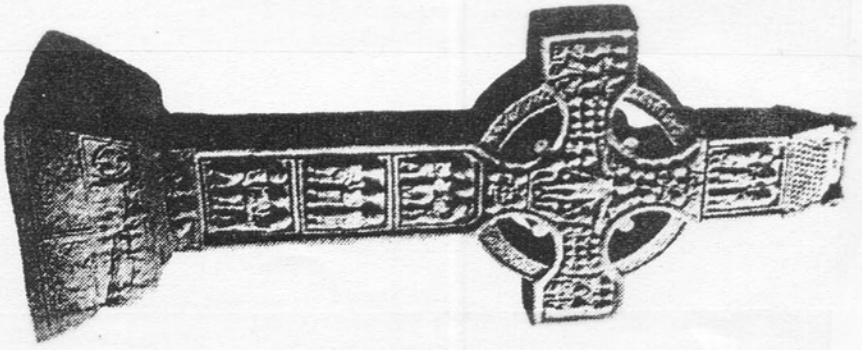

**A New Map of
PEMBROKE
SHIRE,**

Drawn from the best Authorities
By *THO: KITCHIN Esq^r*
*Printer to H. R. M. J. the
Duke of York.*

**CEL TIC
WALLES**

British Statute Miles by a Degree.

1 2 3 4 5 6 7 8 9 10

Longitude West from London

30 40

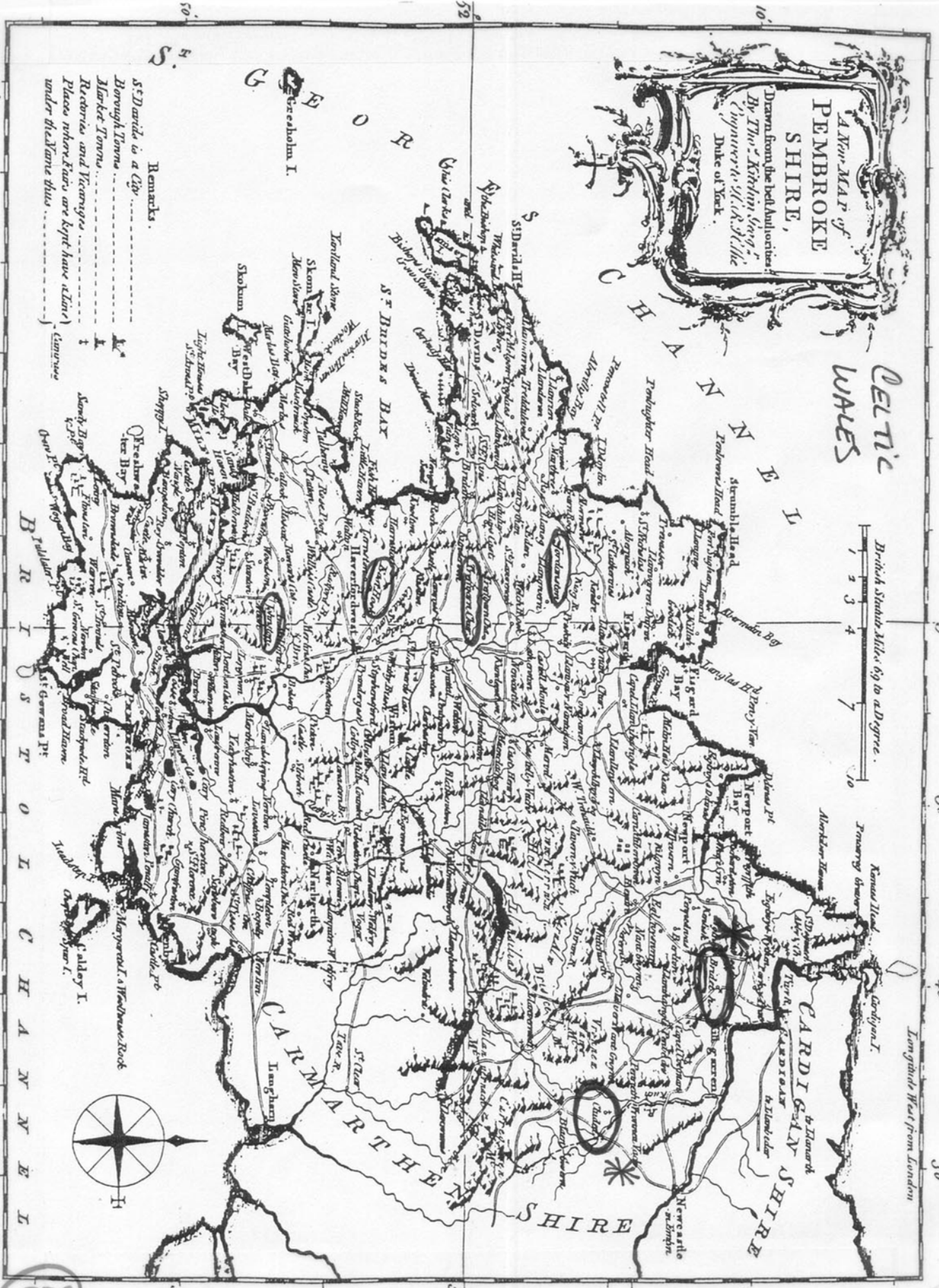

Remarks.

S^d Davids is a *City*

Borough Towns

Market Towns

Rectories and Vicarages

Places where *Walls* are kept have *stars* under the same thus



30 30 30 30 30 30

50 50 50 50 50 50

BRITISH ISLANDS

SAMUEL HUGHES
CLYDY & CASTELL, WALES
(EDUARDES + HUGHES)

YLARIO SANTA CRUZ B. ~ 1722
SAN SEBASTIAN, SPAIN

FRANCISCO ELIAS GONZALES DE ZAYA
LA RIDJA, SPAIN B. ~ 1709

CEVALLOS FRANCISCO PACHECO
TORANZOS, BURGOS, SPAIN B. 1650

PEDRO DE PEREA B. 1591
ANDALUCIA

